



HIPOTRONICS
THE MEASURE OF A LEADER

FEATURES

- Output connected kV meter
- Electronic fault detector
- Current limited output
- Continuously adjustable output control
- Fault totalizing counter
- Contacts for stopping a rewind machine
- Test cage interlock provision
- Solid state rectifiers on DC units
- Compact, light weight, rugged construction
- Hermetically sealed HV section protects against dust and dirt

BENEFITS

- Responds to a fault in less than half a cycle
- Output is current limited to 5mA
- High Voltage Transformers are oil insulated to ensure long life and trouble-free operation
- High fault detection capability
- Non-destructive to insulation
- Output current limiting resistors on DC units prevent shock and possible copper pitting

APPLICATIONS

- Power Cable
- Building Wire
- Insulated, Non-Conductive Tubing

AC & DC Wire Sparkers



DC Wire Sparker

DESCRIPTION

AC & DC Wire Sparkers are designed for efficient and precise insulation testing of wire, cable and tubing. These units are especially suited for production use because of their high fault counting capabilities at fast wire running speeds. The electronic fault detector utilizes a thyatron circuit activated by a sensing resistor in the return leg. Standard Hipotronics electrodes for use with AC and DC sparkers are also available.

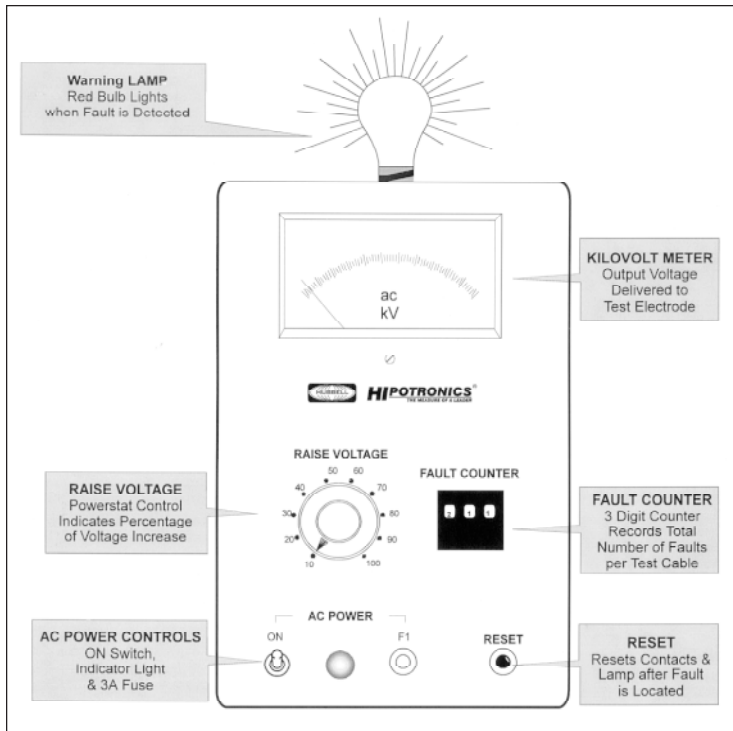

Standard Panel Detail

ACCESSORIES

BEAD CHAIN ELECTRODE (FOR AC UNITS)

FOR CABLES 1" DIAMETER or LESS UP TO 20 kV ac				
MODEL	BOX DIMENSION			ELECTRODE LENGTH
	H	W	L	
SPK500BIB	12" (30½ cm)	10" (25 cm)	12" (30½ cm)	6" (15 cm)

HIPOTRODES® (FOR DC UNITS)

FOR CABLES .25" DIAMETER or LESS UP TO 15 kV dc - 30 kV dc				
MODEL	OPENING SIZE	DIMENSION		
		H	W	L
HIPOTRODE®				
SPK500H	.06" - .5" (1.52 - 12.7 mm)	4½" (11 cm)	3¾" (9½ cm)	7¾" (19 cm)
HIPOTRODE® AND INTERLOCK BOX				
SPK500HB	.06" - .5" (1.52 - 12.7 mm)	6" (15 cm)	6" (15 cm)	14" (36 cm)

SPECIFICATIONS

AC SPARKERS				
INPUT VOLTAGE	Model number suffix - A	115 V/ 60 Hz		
	Model number suffix - B	220 V/ 50 Hz		
OUTPUT VOLTAGE	Model 515	0-15 kV ac		
OUTPUT CURRENT	10 mA, Short Circuit Current			
MODEL NUMBER 515	DIMENSIONS			
	HEIGHT	WIDTH	LENGTH	WEIGHT
	11" (28 cm)	7" (18 cm)	12" (30½" cm)	36 lbs. (16 kg)
DC SPARKERS				
INPUT VOLTAGE	Model number suffix - A	115 V/ 60 Hz		
	Model number suffix - B	220 V/ 50 Hz		
OUTPUT VOLTAGE	Model 420	0-20 kV dc		
OUTPUT CURRENT	5 mA, Short Circuit Current			
MODEL NUMBER 420	11" (28 cm)	7" (18 cm)	12" (30½ cm)	27¼ lbs. (12 kg)

For further information, contact:

Hipotronics, Inc.

A Subsidiary of Hubbell, Incorporated
Route 22, P. O. Box 414
Brewster, NY 10509, U.S.A.

1-800-727-4476

Tel: 914-279-8091

Fax: 914-279-2467

NOTE: Because Hipotronics has a policy of continuous product improvement, it reserves the right to change design and specifications without notice.